



















Quick Guide

Unpacking

Please make sure the package contains the following items:

 	M4x10 screw x 6	 	ST4x20 screw x 6	 	Screw fixing seat x 6	 	M3x6 screw x 2
 	M3x5 screw x 4		Cable buckle x 1		Back over x 1		Stand x 1
	Rope x 1		XT-12P x 1		Wrench x 1		Embedded box x 1
	Silicon rubber sealing ring x 1						

Product Overview

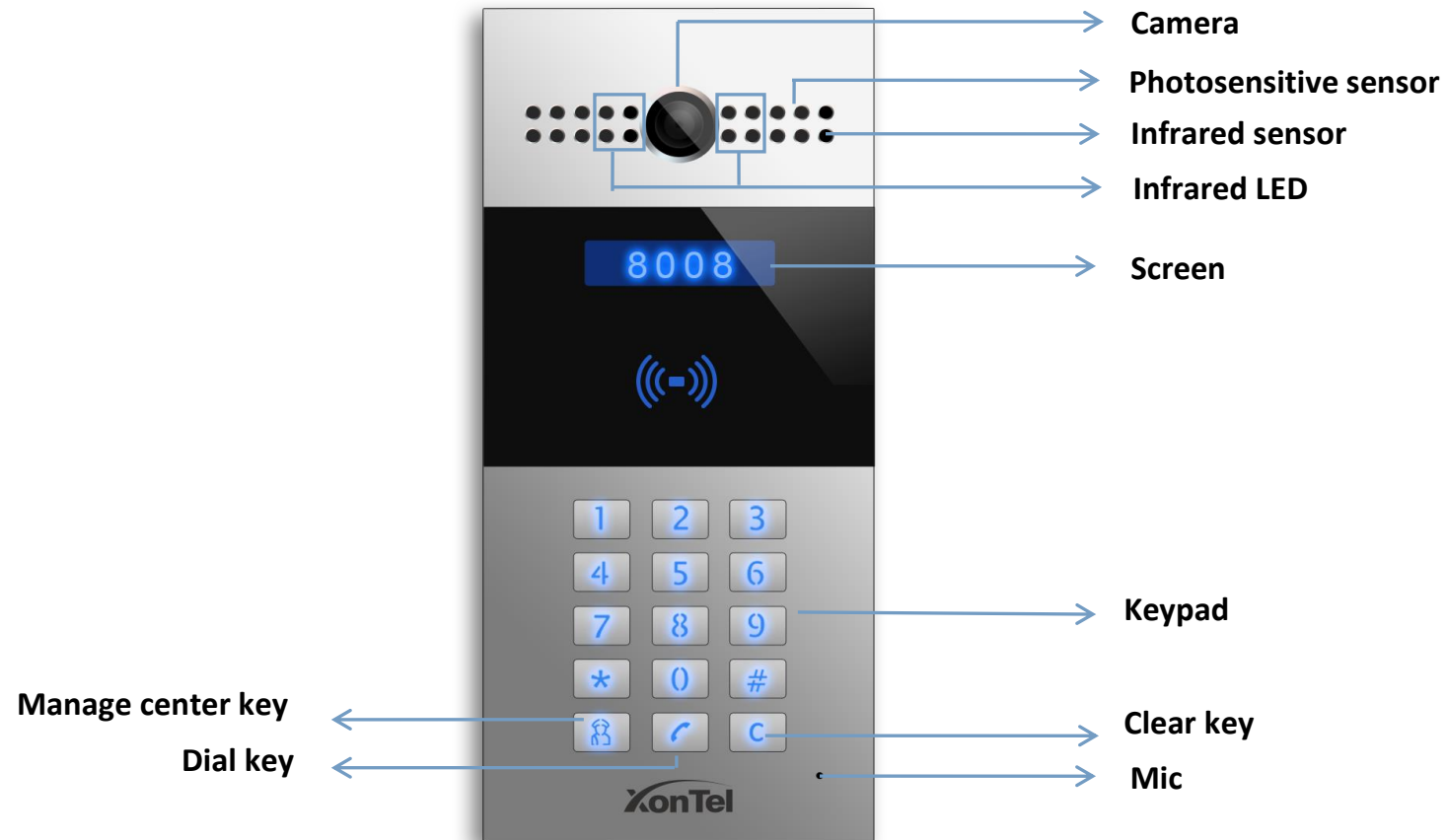

XT-12P IP Intercom

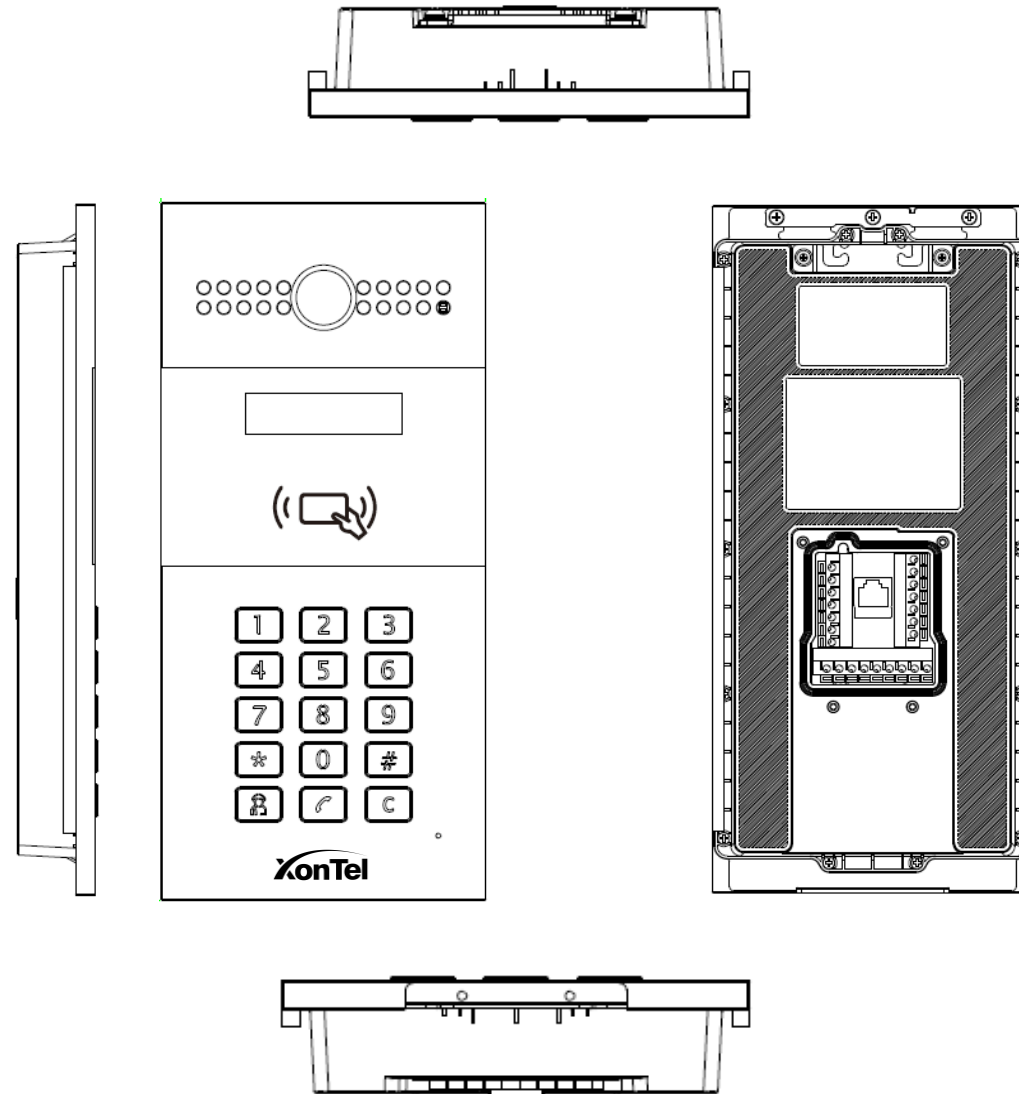

Installation

Wall Bracket Installation

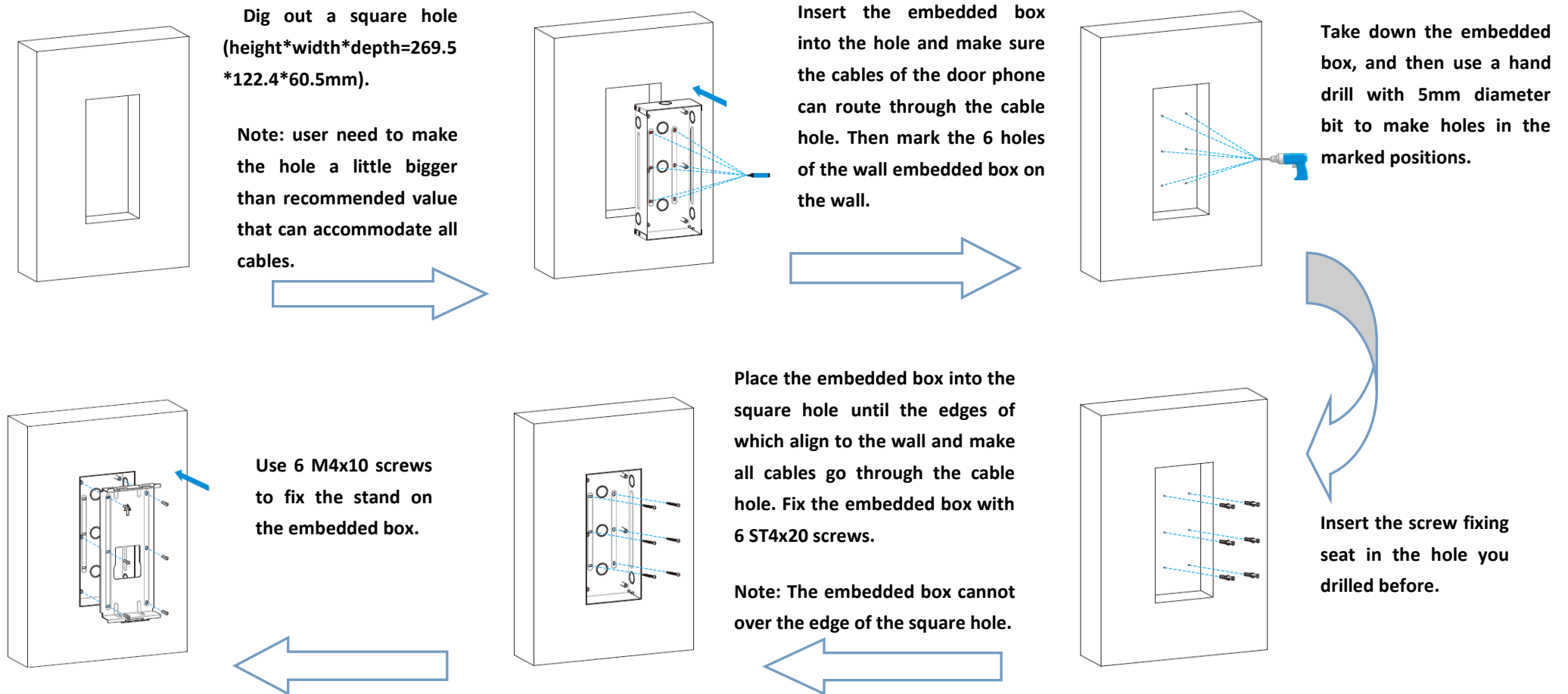

If users don't have ST4x20 screw, please follow the below installation method.

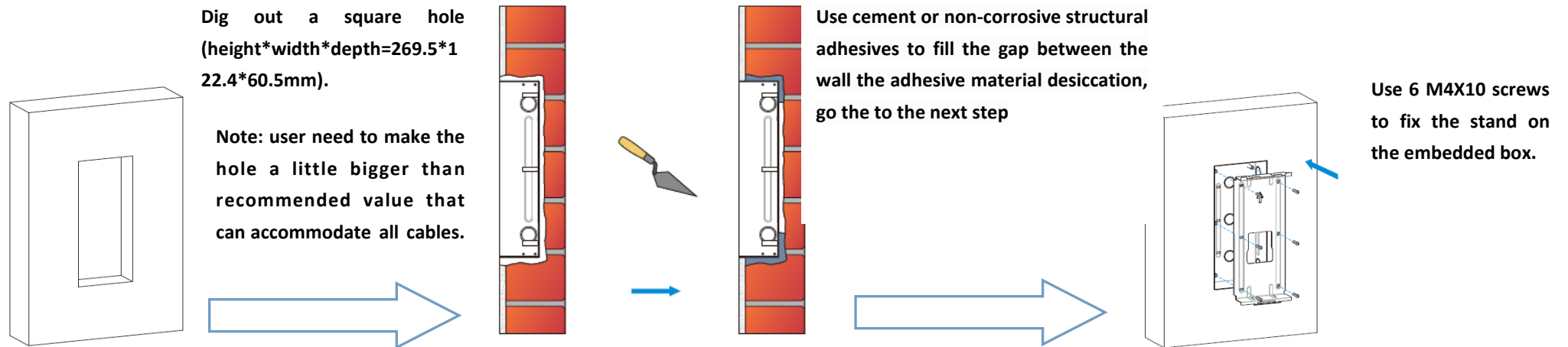

Back cover Installation

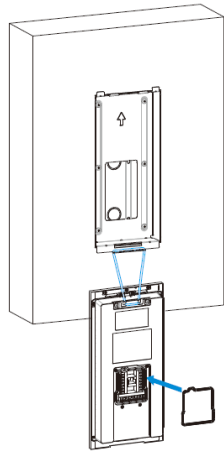

For convenient wiring, hang XT-12P on the bracket with rope then insert the silicon rubber sealing ring into the groove.

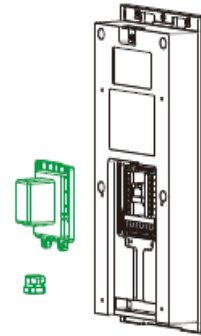

Take down the back cover, cable buckle.

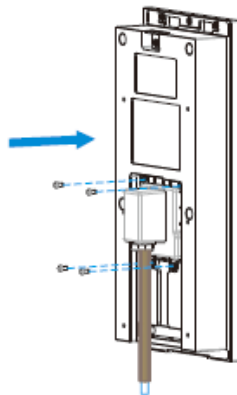

Use 4 M3x5 screws to fix the back cover.

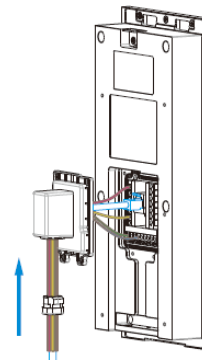

Route the cables of the device through the cable hole; connect to the corresponding interfaces of the main board. Then insert the cable buckle into the back cover.

Device Mounting

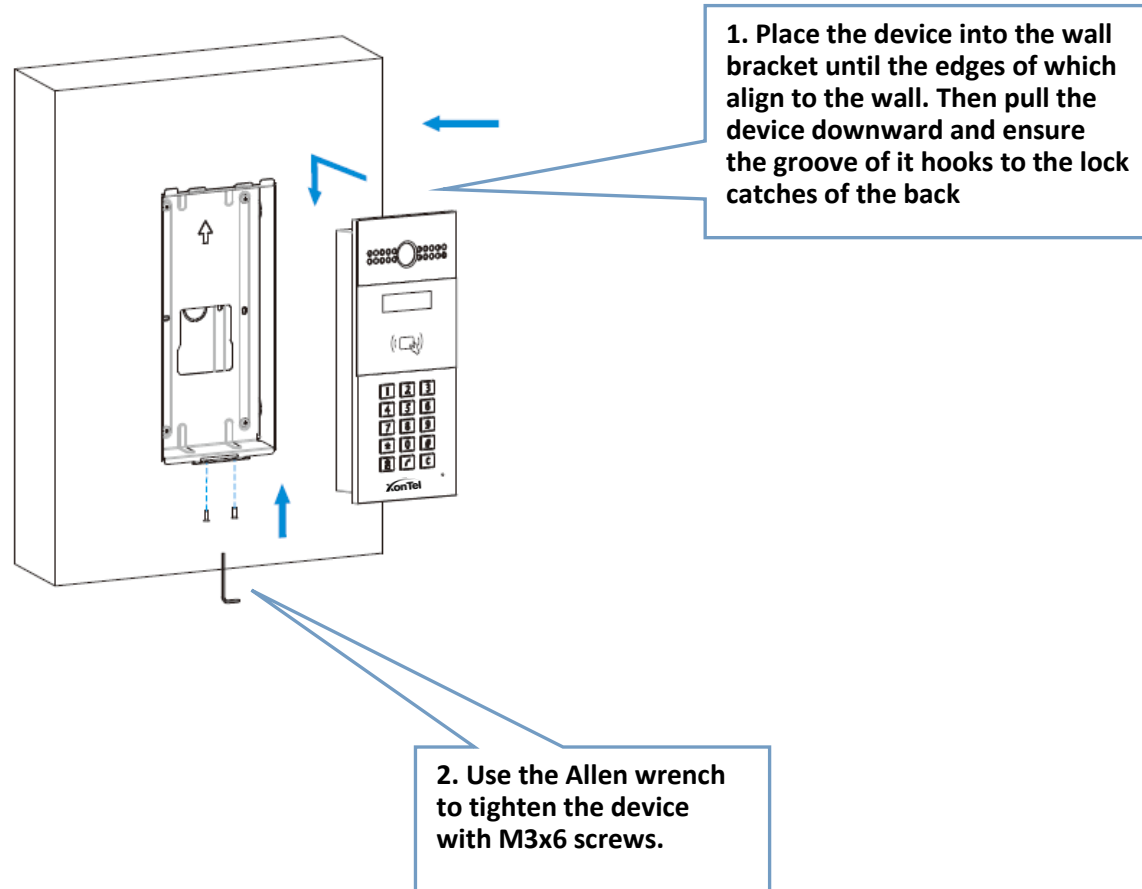

Interface Description on PCB Board:

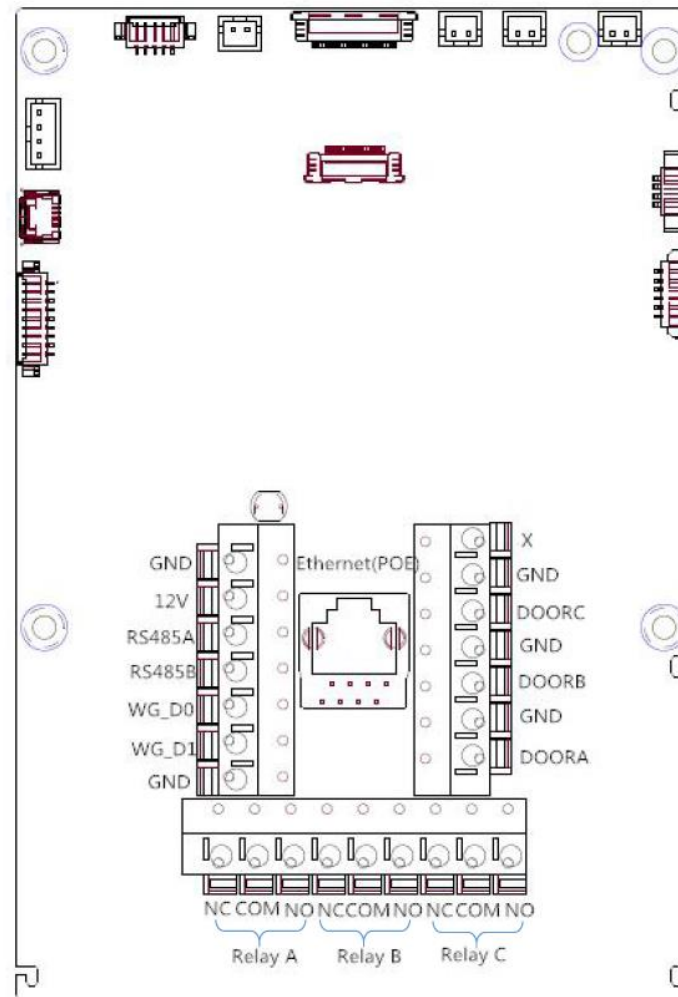

Application Scenario

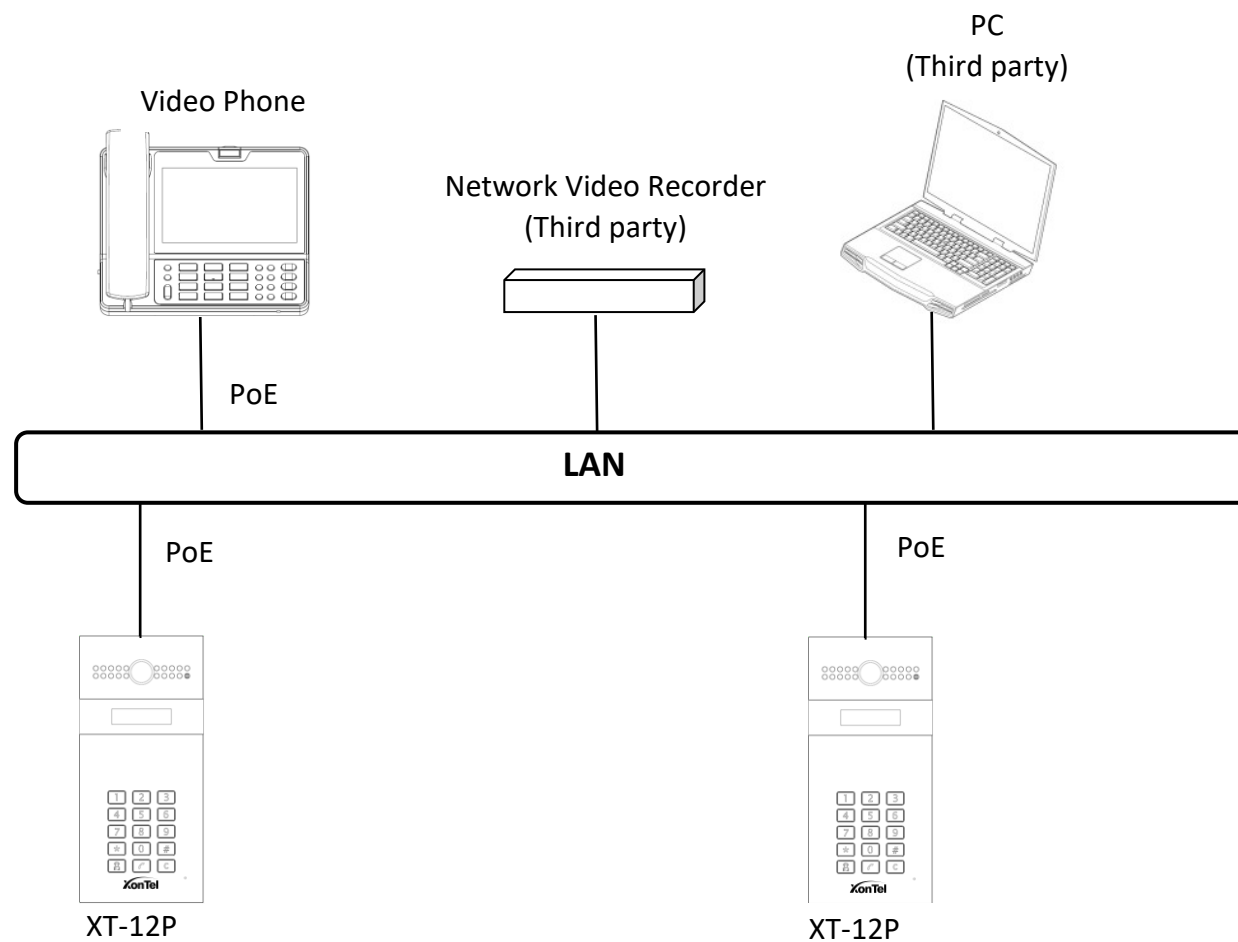

Configuration

1. IP Address Checking: Press *2396# to enter administrator setting interface. Click **System Information** to get the IP address. XT-12P uses DHCP by default.
2. Account Registration: On web UI, go to the path: **Account -> Basic** page to register account and fill in the account information. (*Please refer to user manual for more information*)
3. DTMF Code Configuration: On web UI, go to the path: **Intercom -> Relay & Input -> Relay ID/DTMF** and choose the DTMF code number in corresponding area.

Operation

Make a call

Input the room number, press Dial key to make a call.

Receive a call

XT-12P supports Auto Answer by default. Incoming call from indoor device will be answered automatically.

Unlock by DTMF

During the call, press the corresponding DTMF code in door phone to remote unlocks XT-12P.

Unlock by Private Key

In the idle, enter # + 8 digital password + # to open the door.

Unlock by RF Card (Optional)

Place the predefined RF Card in the RF reader area to open the door.